

# INSTALLATION INSTRUCTIONS PHONOLOOK ECOMONO

## ADHERENCE TO THE CEILING

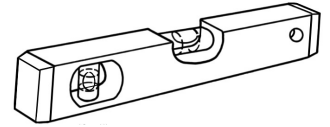
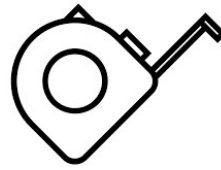
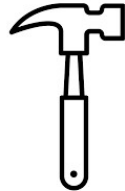

**THE APPLICATOR IS RESPONSIBLE FOR THE CHOICE OF SCREW AND DOWELS.**

PHONOLOOK ECOMONO - CEILING INSTALLATION  
SOLUTION 3 SAFETY POINTS

MAGNET DETAIL Ø 25 mm

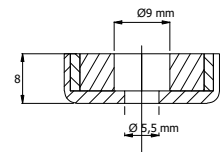
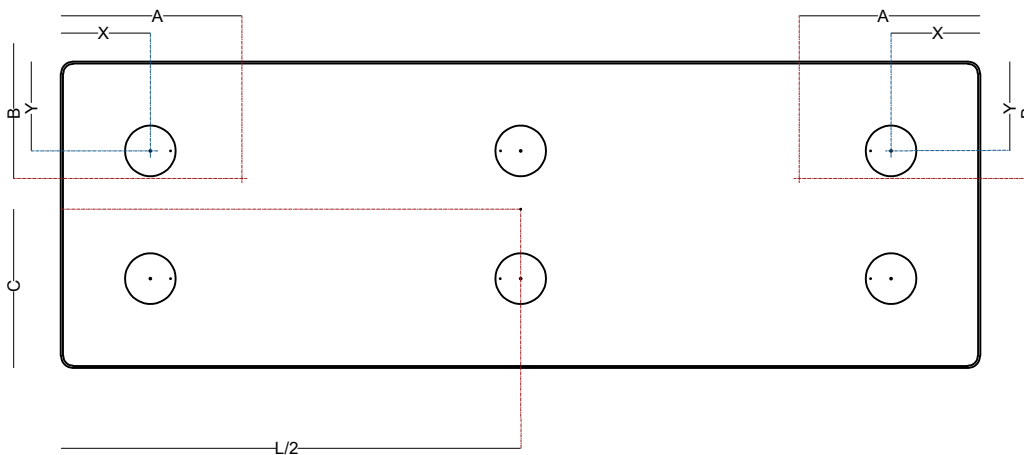

PHONOLOOK ECOMONO - CEILING INSTALLATION  
SOLUTION 2 SAFETY POINTS

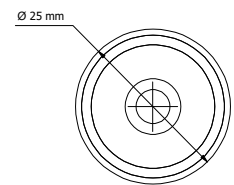
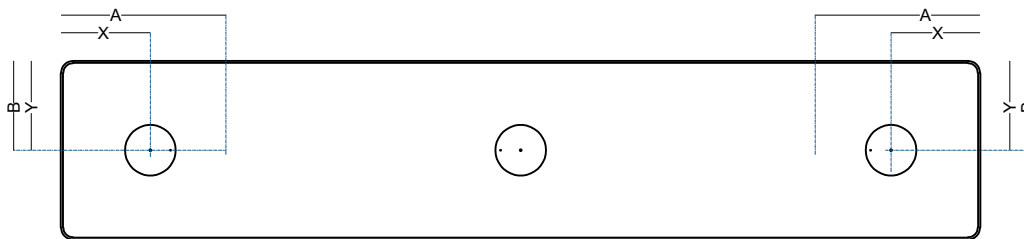

THE DISTANCES OF THE HOLES FROM THE EDGE OF THE PANEL ARE SHOWN IN THE FOLLOWING TABLE CHART.

DIMENSIONS	N° SAFETY POINTS	MAGNETS DISTANCE FROM THE EDGE (*)		DISTANCE OF THE SAFETY POINT FROM THE EDGE			
		DISTANCE X	DISTANCE Y	DISTANCE A	DISTANCE B	DISTANCE C	SAFETY POINTS
300 mm x 1200 mm	2	175 mm	150 mm	215 mm	150 mm	-	1
300 mm x 1800 mm	3	175 mm	150 mm	215 mm	150 mm	-	2
600 mm x 600 mm	4	175 mm	175 mm	215 mm	230 mm	-	2
600 mm x 1200 mm	4	175 mm	175 mm	215 mm	230 mm	-	2
600 mm x 1800 mm	6	175 mm	175 mm	215 mm	230 mm	350 mm	3
1200 mm x 1200 mm	4	175 mm	175 mm	215 mm	230 mm	-	2



POINT  
1

## DRILLING

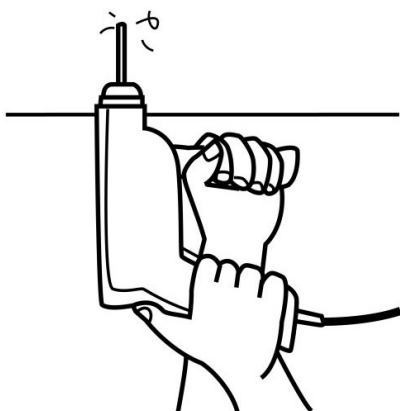

1. DRILL A HOLE IN THE POINTS INDICATED IN THE TABLE CHART.



POINT  
2

## MAGNET FIXING

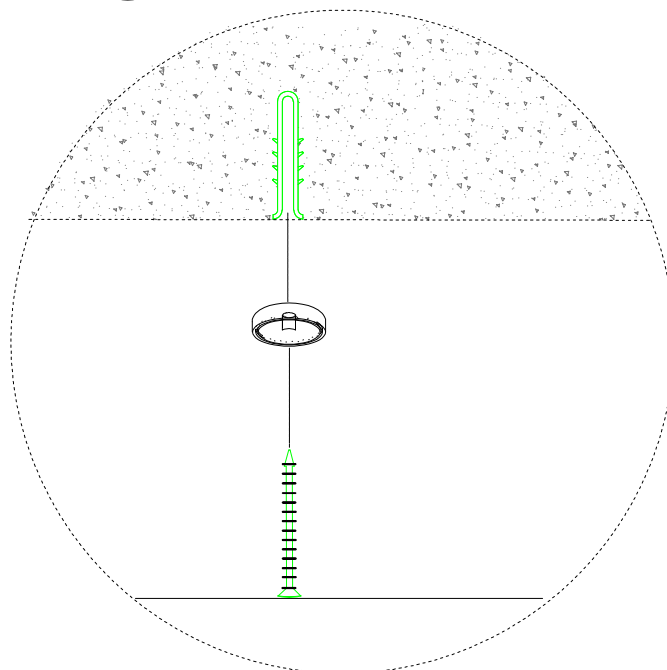

2. INSERT THE EXPANSION DOWEL.
3. FIX THE MAGNET WITH THE SCREW.



POINT  
3

## SAFETY CABLE FIXING

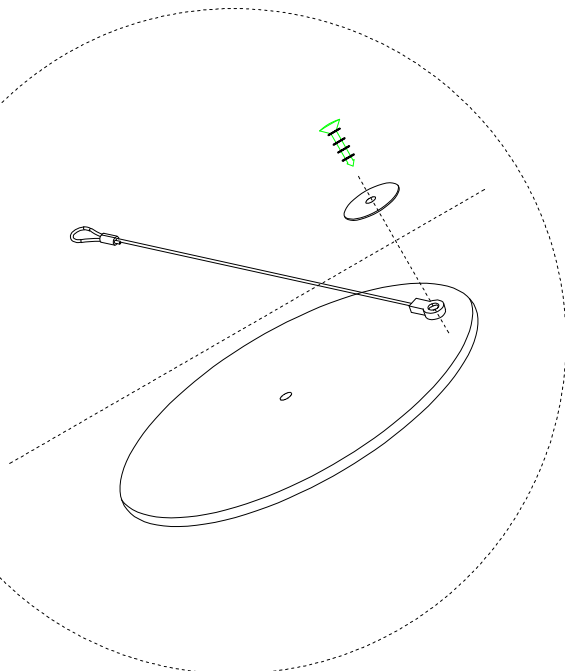

4. FIX THE CABLE WITH THE SCREW IN THE HOLE OF THE PLATE, PLACING THE SUPPLIED WASHER.



POINT  
4

## FIXING THE SAFETY CABLE IN THE CEILING

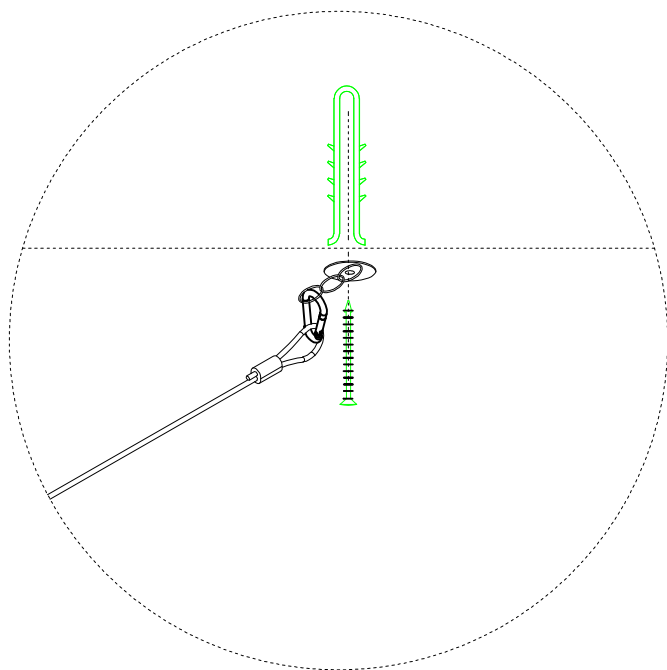

5. INSERT THE EXPANSION DOWEL.
6. FIX THE CHAIN WITH THE SCREW, PLACING THE SUPPLIED WASHER.



POINT  
5

## PLACEMENT OF THE PANEL

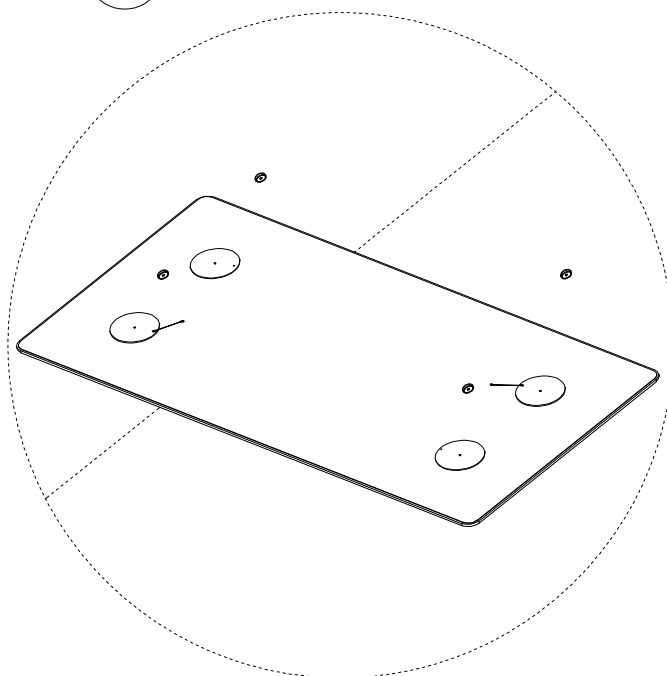

7. PLACE THE PANEL



POINT  
6

## FINAL CHECK

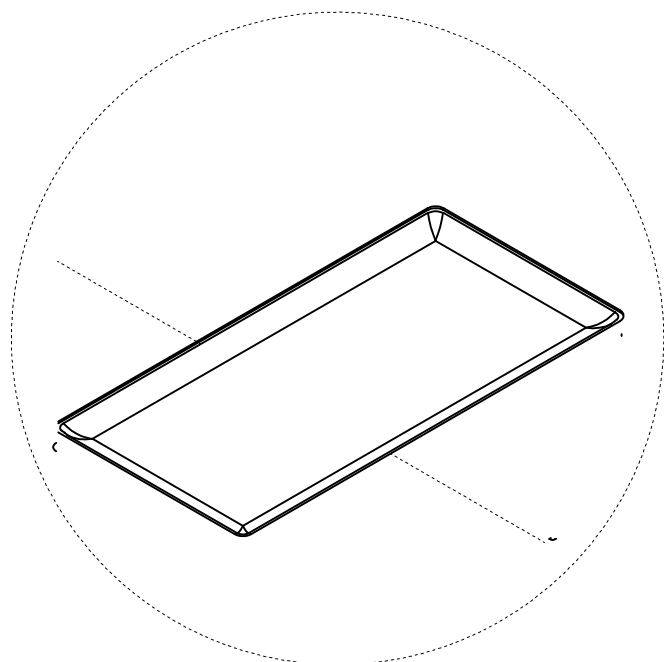

8. MAKE SURE THE MAGNET IS ENTIRELY ON THE PLATE.
9. VERIFY THE CORRECT PLACEMENT OF THE PANEL.